

KOICA-SNU GSIS

Master's Degree Program in National Development Policy for African Countries

August 12, 2019–December 31, 2020

Seoul & Seongnam, Republic of Korea



Korea International Cooperation Agency



Graduate School of International Studies
Seoul National University

Participants are strongly advised to thoroughly read and follow the instructions provided in the Program Information.

Contents

PART I. PROGRAM OVERVIEW	1
PART II. PROGRAM CONTENTS.....	3
PART III. TRAINING INSTITUTE	15
PART IV. ACADEMIC REGULATIONS	21
PART V. REQUIRED DOCUMENTS.....	23
PART VI. CONTACTS.....	25

I . PROGRAM OVERVIEW

■ Program Title:

KOICA-SNU Master's Degree Program in National Development Policy for African Countries

■ Duration:

- **Stay duration: August 12, 2019—December 31, 2020 (17 months of study in Korea)**

* During their 17 months in SNU, students are strongly recommended to complete their thesis

- Academic duration: September 2019—August 2021 (24 months)

* In accordance to the university regulations, the diploma will be issued in August 2021.

■ Degree: Master of International Studies (International Area Studies, International Commerce, International Cooperation)

- **Students must choose one of the three majors.**

- **The chosen majors will be specified on students' degrees.**

- **Required courses will change based on the chosen major.**

■ Objectives:

- 1) This capacity reinforcing program, aligned with the KOICA's Scholarship Program (SP), was designed to achieve the original goal of the SP.
- 2) Program purpose: To nurture the participating countries' human resources; to help strengthen organizational competency; to give support to the national development of African countries in the area of policy development system; to raise understanding of Korea; and to build amicable relations between Korea and participating countries.
- 3) Expected Effect: Strengthen personal and organizational competencies in the field of national development; achieve economic and social development in participating countries by implementing improved policies learned from the program; and reinforce partnership between Korea and participating countries

■ **Training Institute:** Graduate School of International Studies, Seoul National University

■ **Number of Participants:** 20 Government Officials

■ **Language:** English fluency that requires no translation

■ Accommodations:

- 1) KOICA International Cooperation Center (ICC) during the KOICA Orientation
- 2) Seoul National University Dormitory (SNU Gwanak Residence Halls): This dormitory is located within walking distance to the GSIS on the Seoul National University campus.
 - Double occupancy: 2 people per room
 - Each room is furnished with two beds, desks, cabinets, a LAN port, an air conditioner and a shower booth.

- Communal Area (Shared): Kitchen, Reading Room, Laundry and Drying Room and Lounge
- ***Halal food is not offered in the dormitory cafeteria.***

II. PROGRAM CONTENTS

1. ACADEMIC SCHEDULE

Session	Date (YYYY.MM.DD)	Contents/ Remarks
Preparatory Session	2019.08.12 ~ 08.15	Arrival in Korea, Move to the ICC KOICA Orientation Medical Check-up
	2019.08.16	Arrival in SNU, Move-in Entrance Ceremony
Pre – Courses	2019.08.19 ~ 08.30	(2 weeks)
2019 Fall Semester	2019.09.02 ~ 12.13	(15 weeks)
2019 Winter Semester	2019.12.23 ~ 2020.01.28	(5 weeks)
2020 Spring Semester	2020.03.02 ~ 2020.06.12	(15 weeks)
	2020.05.06 ~ 05.17	Thesis proposal
2020 Summer Semester	2020.06.22 ~ 07.24	(5 weeks)
2020 Fall Semester	2020.09.01 ~ 12.11	(15 weeks)
	2020.11.02 ~ 11.20	Thesis Defense
	2019.12.	Graduation Ceremony
	2019.12.31	Departure

* The above schedule is subject to change.

** A detailed Program Schedule will be provided upon arrival.

2. CURRICULUM

1) Curriculum & Credits

- The total number of credits required to complete the Master's program: 39 credits
(All 3 credits per course)

Semester	Type	Credits	Course Title
Preparatory Session		-	<ul style="list-style-type: none"> • Basic Economics • Basic Statistics • Basic Korean
2019 Fall 3 courses (9 credits)	Required	6	<ul style="list-style-type: none"> • International Economic Relations or International Cooperation (depending on the student's major) • Research Methodology and Skills • Basic Korean (preparatory class & non-credit)
	Elective	3	<ul style="list-style-type: none"> • Understanding African Governance and Politics (It is not registered as an officially required course for graduation but is mandatory for students taking this program)
2019 Winter 2 courses (6 credits)	Electives	6	<ul style="list-style-type: none"> • Special Studies in International Cooperation (Special Issues in International Development Cooperation) • Research Project in International Area Studies 3 (Thesis Workshop1)
	Required	-	<ul style="list-style-type: none"> • Basic Korean (preparatory class)
2020 Spring 3 courses (9 credits)	Required	3	<ul style="list-style-type: none"> • Studies of International Development Cooperation Policy and System • Korean Language and Culture (non-credit)
	Electives	6	<ul style="list-style-type: none"> • Financial Development of World • Research Project in International Area Studies 3 (Economic Development in Latin America, Asia, and Africa) • Economic Growth and International Development • World Trade Organization & Multilateral Trade Agreements • Social Development and International Development Cooperation • Social and Political Theories of International Development • Labor and Social Policy in Globalizing Economy • Transnational Migration and Sociocultural Issues • Modern Korean History and Society • <i>Free Choice Class offered by GSIS</i>
2020 Summer 2 courses (6 credits)	Electives	6	<ul style="list-style-type: none"> • Seminar on Area Studies (Conflict and Cooperation in East Asia: Economic Interdependence and Security) • Research Project in International Area Studies 3 (Thesis Workshop2)
2020 Fall 2 courses	Electives	6	<ul style="list-style-type: none"> • History of Africa's External Relations • International Financial World: Markets, Institutions, and Policies

Semester	Type	Credits	Course Title
(6 credits)			<ul style="list-style-type: none"> • Exchange Rates and International Macroeconomics • Topics in International Commerce (Advanced Studies on the WTO Dispute Settlement System) • Advanced Topics in International Development • Seminar in International Commerce 2 (Development Cooperation Theory and Practice) • Understanding International Development Cooperation • Understanding International Human Rights and Refugee Issues • Political Development and Economic Cooperation in East Asia • Comparative Legislative Politics
2021 Spring 1 course (3 credits)	Required	3	<ul style="list-style-type: none"> • Dissertation Research

* The above curriculum is subject to change.

➤ Course Descriptions

- Basic Economics (Preparatory Session)

This course provides an introduction to current economic issues and to basic economic principles and methods. Economics is not primarily a set of answers, but rather a method of reasoning. By the end of this course, you will be able to use the analysis practiced in the course to form your own judgments about many of the major economic problems.

- Basic Statistics (Preparatory Session)

This course is an introductory course for students who are not majoring in statistics, but require the fundamental knowledge of statistics for their social scientific research. The course covers the basic principles of statistical inference and hypothesis testing as well as descriptive statistics. It also addresses simple and multiple regression analysis at the beginning level. Each class consists of a theoretical part and a practical part, by which students are given the chance to practice the theoretical elements of statistics through excel and STATA.

- Basic Korean

Aim: This is an introductory course for the Korean language. Students are expected to be able to read and write 'Hangeul'. This course aims to improve their ability to greet each other with simple Korean sentences. For the learners who are not familiar with Korean, this class focuses on real situations, such as introducing oneself.

Contents: This course offers instructions on how to read and write 'Hangeul' with basic pronunciation. It also trains students for communicating in everyday situations so that the students can use the basic sentences properly while learning the basic expressions.

- International Cooperation (Required)

This course is designed as an advanced introduction to contemporary theories, debates, and major scholarly traditions in international relations. The primary concern of the course is to examine and assess contending theories of international relations and to logically answer some major international questions of contemporary relevance. The ultimate goal is to enhance students' capacity to think critically about the basic forces that drive foreign policy and international politics, thereby improving their ability to evaluate important real-world issues.

- International Economic Relations (Required)

This course introduces students the basic theories that explain (1) international trade relations among countries, (2) international macroeconomic relations, and (3) the operation of international monetary systems and financial markets. It provides a systematic exposition of principles and techniques of economic theory that are useful in analyzing economic aspects of trade negotiations. Furthermore, attention is given to various concepts of future international economic orders.

- Research Methodology and Skills (Required)

The purpose of this course is to give students critical thinking skills related to communication and research. Critical thinking is a powerful means of learning that transcends traditional learning methods focused on memorization and recall. Critical thinking emphasizes engaged, independent and creative thinking through the use of skills related to analysis, reflection and meaningful understanding.

- Studies of International Development Cooperation Policy and System (Required)

The goal of this course is to promote the understanding of the history and current issues of international development cooperation policy and system and also the research and debate about the measures to progress the international development cooperation. We review how the international society of development cooperation has been formed and figure out the current situation of international development cooperation, and study various instruments of development cooperation such as knowledge sharing, triangular cooperation, development finance, PPP, and CSV. We study critical topics regarding the design of the system of international development cooperation and also set up the discussion sessions with development cooperation experts in order to deliver opportunities for the students to practice their real understanding from the course.

- Korean Language and Korean Culture 1 (Required)

The goal of this course is to effectively implement the Korean language and cultural education for foreign graduate students. Through this course, the students will learn the Korean language and develop skills in reading comprehension, speaking, listening as well as in reporting and writing. Also, in order to understand Korean culture, students will study

sentence patterns and vocabulary, as well as gain cultural experience through Korean folk games. This can be substituted for Korean Proficiency Exam for Foreign Students, which is one of the pre-requisites for their thesis.

- Understanding East Asia (Elective)

The purpose of this course is to familiarize students with key patterns in political change, economic development, and socio-cultural imagination in East Asia. The course briefly reviews the contemporary history of East Asia before moving on to different perspectives of economy and business, society and culture, and politics and diplomacy. Topics include the development of East Asian capitalism, developmental states and democracy in East Asia, cultural understanding of Asian Values, and the concept of self and others in China, Japan, and Korea. The course will end with a consideration of recent social and political changes in East Asia that are aligned to international resources.

- Studies in Regional Monetary and Financial Integration (Elective)

Regional monetary integration is one of the two pillars characterizing the regionalization of world economy together with regional trade integration. This course is divided into two parts. Considering regional integration in the broadest context of economic, political and social aspects, this course is first of all intended to think about the role of individuals, state and international arrangements. Against this backdrop, this course then explores diverse regional monetary and financial arrangements around the world, drawing lessons largely from European monetary integration process.

- African Governance and Politics (Elective)

This course is designed to understand and rethink the general aspects of African Affairs and the main objective of this course lies in deconstructing the existing misperception on African Continent and reconstructing a more balanced perspective. The reconstructed perspective will, hopefully, lead a more balanced practice in the field for future practitioners. To achieve the goal of our course, the approach will be interdisciplinary and thematic. First, the course is based on a wide variety of disciplines ranging from history, sociology, archaeology, political science, development theory, IR theories etc.

- Financial Development of World (Electives)

This course is intended to explore the development of money, banking and finance in Europe, US and East Asia in comparative financial history perspective. Through this course, students are expected to understand different financial systems and financial crises of the world.

- Research Project in International Area Studies 3 (Economic Development in Latin America, Asia and Africa) (Elective)

The purpose of this course is to provide students with a unique research opportunity by assisting them in synthesizing their course work on various aspects and levels of

development, as it relates to their chosen functional and regional (Africa, Latin America, and Asia) focus. By requiring students to write a major seminar paper and to present it in class for discussion and critique, this course introduces students to a wide range of practical tools for project designing, monitoring, and evaluation for the practical studies of contemporary Latin American economy.

- Economic Growth and International Development (Electives)

Main goal of this course is to study theoretical models and empirical tools in understanding the process of economic growth and international development. The central question of this course is how to make poor countries rich. To answer this question, we try to understand the sources of the international differences in levels and rates of change of real income and the associated income distribution dynamics within as well as across countries. We learn about these issues by using both theoretical models and empirical data interactively in order to infer the policy implications for the effective development of nations.

- World Trade Organization & Multilateral Trade Agreements (Electives)

This course covers World Trade Organization (WTO) and multilateral trade agreements established through the Uruguay Round negotiations. We will first overview the WTO and then focus in somewhat detail the final results of the Uruguay Round of multilateral trade negotiations. We divide multilateral trade agreements into four parts: trade in goods, trade in services, trade-related aspects of intellectual property rights and institutional issues. Agreements on trade in goods are further divided into three subcategories: market access, customs-related issues, and trade rules. Lastly, this course will look at the future challenges facing the current multilateral trading system. Although this course deals with trade agreements, it will put more emphases on economic interpretation rather than the legal aspects. For this course, outside scholars and experts from policy, academic, and private sectors may be invited as special guest lecturers.

- Social Development and International Development Cooperation (Elective)

This course is designed to introduce a new approach to social development to the existing economic growth-oriented paradigms in the field of international development cooperation. By presenting and comparing a variety of international organizations dealing with social development programs, this course aims to enhance both theoretical and practical learning effects on social development. The first part of the course will introduce norms and theories of social development which have been shared among international organizations; and the second part will lead to practical issues specializing in diverse agendas such as labor, human rights, local communities, immigration, environment issues, gender, and civil society.

- Social and Political Theories on International Development (Elective)

This course is a logical outgrowth of academic endeavors to collect possible scenarios and theoretical frames, all of which provide explanatory alternatives of social and political

aspects of international development beyond the dominant paradigm of economic solutions. In this regard, this course is theory-oriented and assumes that all students who take this course have pre-knowledge on main thoughts of political science and sociology.

- Labor and Social Policy in Globalizing Economy (Elective)

It is contended that globalization has increased income inequality due to increased competition from abroad. Those who could compete successfully (for example, skilled knowledge workers) have continued to prosper but those who lost (for example, routine manual workers) have faced a sharp decline in income level. And this trend is likely to rise as globalization becomes intensified. It is also argued that globalization has pushed governments engaged in a "race to the bottom". National governments have been forced to strip away business regulations, reduce welfare programs, and lower labor and environment standards in order to attract more foreign capital and business or to keep local industries at home. To what extent the above contentions are true and warranted by empirical evidence? To the extent they are true, what institutional inventions do we need and what policy options do we have to slow down these trends or to revert them and finally to make globalization serve for the benefits of all people, not just for those of lucky few? With such issues in mind, we will deal with the interactions between globalization on one hand and labor, education, welfare, civil society, and regionalism on the other.

- Transnational Migration and Sociocultural Issues (Elective)

Increasing transnational migration generates very diverse sociocultural issues on a global scale. Transnational migration also often provides care workers and becomes a source of international marriage in many developed countries. This course approaches transnational migration in relation to various sociocultural issues such as identity, assimilation and social integration.

- Modern Korea History and Society (Elective)

This course improves student's understanding important issues in modern Korean society. First of all, this course provides an explanation of the status of the Korean Peninsula in the World arena. Moreover, students will deal with crucial topics in modern Korea history, like the division, the Korean War, and the economic growth, and will examine changes in Korean society after modernization. To illuminate North Korean history and society is covered for understanding current Korean issue.

- Global Social Governance (Electives)

This course is designed to deal with new social problems which take place beyond the traditional territories of nation-states under the pressure of globalization. They include a variety of new emerging societal issues such as climate change, human rights, poverty reduction, disease, immigration and so on. By upgrading the frame of social policy which has been mostly considered a traditional sovereignty of nation states to the global level, this course will introduce not only various theoretical approaches to global social

governance but also empirical analyses of globalized social policies to tackle these new social problems.

- International Conflict Analysis and Development Strategy (Elective)

This course is designed to understand the current nature of international/transnational political issues and to enhance critical and decisional capabilities by understanding the intricate patterns of interactions among the different spheres of global conflict/security fields. To obtain this objective, the course is organized on three different facets: 1) conceptual and normative understanding of international conflict (identification of 'problematic'), 2) socio-historical analysis with genealogical-archeological comprehension on international conflict/security issues (scientific analysis of problem) and 3) thematic examination on various current cases (political, economical and/or cultural conflicts) accompanied by a specific consideration for possible practical solutions (ethico-practical proposition mainly by focusing on development strategy).

- History of Africa's External Relations (Elective)

This course introduces a critical study of the formation of African historical (internal and external) perceptions by examining African relations with external world based on a variety of academic perspectives (history, political science, anthropology, archeology, literature, etc.). The goal is to form a balanced perception of African relations and to establish the basis for a sound mutual recognition between Korea-Africa in order to establish a meaningful future partnership.

- International Financial World: Markets, Institutions, and Policies (Electives)

This course will cover both macroeconomic and microeconomic aspects of international finance. This course will also cover institutional aspects of the international capital market. Through combining theory and real practices in the international market, students will understand how the international financial market works, learn various kinds of financial products which are transacted internationally, and study international financial companies and related institutions. Considering these characteristics, this course will be one of the prerequisites for becoming an international specialist in the 21st century.

- Exchange Rates and International Macroeconomics (Elective)

The main purpose of the course is to understand the reason for adopting protectionist measures not only in advanced countries but also in developing countries despite the fact that free trade policy is better than protectionism. Understanding the political aspect of trade policy is very important to trade negotiators as well as students with an interest in trade negotiations, because this aspect is so crucial in formulating the basic position and strategies of trade negotiations, and also because it is needed when governments present the results of trade negotiations to the general public.

- Topics in International Commerce (Advanced Studies on the WTO Dispute Settlement System) (Electives)

In our increasingly contentious society and world, more than ever before, a prudent selection of a proper, appropriate method of resolving or settling conflicts/disputes becomes one of the most important tasks of individuals, organizations, communities, societies, and nations. This course will provide students an opportunity to explore three of the most frequently used methods of dispute resolution; namely, mediation, arbitration, and litigation. Through lectures, simulations, and student presentations, students will learn the procedures and actual workings of these three methods in various settings such as WTO, WIPO, and LCIA, internal

- Advanced Topics in International Development (Electives)

The goal of this course is to understand and apply the empirical methods in analyzing various phenomena of international development. The main contents include (i) understanding of hypotheses of explaining the macroeconomic mechanisms of cross-country differences in development as well as those of the microeconomic mechanisms of development, (ii) understanding of empirical tools and the background quantitative and statistical methods to test such hypotheses, and (iii) application and exercises using actual data based on such understanding. This course ultimately aims to provide the empirical understanding of the fundamental sources of differences in international development based on real and solid evidence.

- Seminar in International Commerce 2 (Electives)

The purpose of this course is to understand the nexus between theories and practices and to acquire the proper tools to analyze the possible practical situations in working places. The lecture content will be based on the experience of experts working in the field of international commerce. Students will have two hours' practice of international commerce per week as the preparation for actual field experience.

- Understanding International Development Cooperation (Elective)

This course is designed to deliver the various aspects of foundational theories, historical development, and practical policies in relations to international development cooperation. They includes the following four criteria: (i) international development theories (development economics, social development, political development, and anthropological perspectives); (ii) international development history since the Second World War; (iii) development policy transfers on the basis of actors including states, international aid agencies, NGOs, etc., and (iv) global development architecture.

- Understanding International Human Rights and Refugee Issues (Elective)

This course surveys international human rights norms and procedures, including a detailed examination of global, regional, and national institutions to protect human rights. The course examines key contemporary concepts of human rights and the mechanisms of

creating and enforcing human rights norms. Particular attention is paid to refugee issues, which has emerged one of the most serious human right problems in the Post-Cold War world.

- Political Development and Economic Cooperation in East Asia (Elective)

This seminar examines the relationship between economic developments and democratization in East Asia like South Korea, Japan, Taiwan and China. Special attention will be paid to related topics such as previous theories of economic development and democratization (i.e., modernization theory, dependency theory, bureaucratic authoritarianism, and developmental state model), the democratization process in the third world, and democratic transition in socialist states like China, Vietnam and North Korea.

- Comparative Legislative Politics (Elective)

This course is a customized research course designed to offer students in–depth knowledge and guidance regarding a subject given by a professor of Korean Studies Program. The subject may change depending upon the specialization of professors every semester, and students write in depth practice – oriented research papers. The professor teaches students how to use relevant theories, and research methods.

2) Graduation Requirements:

- ① A minimum of 39 credits is required for graduation (including a minimum of 9 credits from Practical Courses). GPA of 3.0 or higher out of 4.3 is required.
- ② Students should take the following 4 required courses:
 - International Economic Relations OR International Cooperation (depending on their major)
 - Research Methodology and Skills
 - Studies of International Development Cooperation Policy and System
 - Dissertation Research (Student should take “Dissertation Research” in their 4th Semester)
- ③ Students must take at least 3 courses (9 credits) in the International Area Studies program
- ④ Students must take at least 3 practical courses (9 credits).
- ⑤ Korean courses are mandatory (non-credit courses). Even though Korean classes are shown as 3-credit courses when you register for them during a semester, they will not be included in your overall GPA calculation.

➤ **Thesis**

① **Thesis submission process**

- In order to write a thesis, students have to pass the thesis qualifying exam. For students taking this program, the thesis qualifying exam will be in English on two major subjects:

- 1) International Economic Relations OR International Cooperation (Select one)
 - 2) Studies of International Development Cooperation Policy and System
- Once students meet the prior requirements, students can submit a thesis proposal to the advisor of their choice. Once the thesis advisor approves the proposal, students then have to submit their proposal, together with the approval from the advisor, to the administration office.
 - As for the Korean exam, students can take a Korean course instead to receive a passing grade. In this case, grades received in the Korean course will not be included in the GPA, but students will not be able to graduate if they fail the course.

② Thesis Screening Process

Period	Detail
January 2020	Confirmation of Thesis Screening Committee
April 2020	Submission of the Thesis Proposal Application Form
May 2020	Submission of the Thesis Proposal and Thesis Abstract
May 2020	Thesis Proposal
June 2020	Submission of Thesis Proposal Results
August 2020	Thesis Qualifying Exam
November 2020	Submission of Thesis Defense Application Form
November 2020	Submission of Thesis Defense
November 2020	Thesis Defense
November 2020	Submission of Thesis Defense Result
December 2020	Completion of Thesis and Receipt

*The above schedule is subject to change.

- ③ Aside from 'Dissertation Research' course, students can choose one of the SNU GSIS professors as their thesis adviser before the second semester starts and the adviser will offer you 1:1 individual thesis guidance.
- ④ Thesis Workshops: 4 times during the academic year

3. EXTRACURRICULAR ACTIVITIES (TENTATIVE)

1) **Field Trips & Industrial Visits** *Locations are subject to change.

- Industrial sites: Hyundai Motor Company, POSCO Steel, Hyundai Heavy Industries (ship), Saemangeum Reclamation Project Sites and etc.
- Public Offices sites: Cheong Wa Dae (Office of the President), National Assembly, Sejong Government Complex, Information Network Village in Gyeonggi-do and etc.
- Others: Other provinces in Korea (Jeonju, Pohang, Busan, Gyeongju, and others), DMZ
- Field trips are usually on a monthly basis, except for months with mid-term or final exams.
- Since the field trip is part of the official schedule of the whole program, a prior approval from the professor in charge is mandatory if you have to be absent on that day.

2) **Seminar on International Development Policy (3 times per semester)**

The purpose of the seminar is to invite specialists and practitioners in the field of policy-making to provide a better understanding of the study. Through case studies and practical knowledge to be offered by the experts, students will be able to gain valuable knowledge on how to apply Korea's experience to their home countries. Students can actively interact with the specialists during the Q&A session. Participation is highly encouraged and recommended.

3) **Roundtables (once a week)**

Roundtables are designed to provide students opportunities to exchange their thoughts and ideas on various issues in a more casual atmosphere. At SNU GSIS, multiple roundtables are being held and actively run by students. Many students taking this program participate in roundtables like the Korean Roundtable and the Developing Countries Roundtable. Each session is divided into two parts: presentation by students and subsequent discussions. Usually, roundtables take place during lunch time on weekdays.

4) **Experiencing Korean Culture (2 times)**

III. TRAINING INSTITUTE

1. GENERAL INFORMATION

1) About University

Seoul National University (SNU) was founded in 1946 as the first national university in South Korea. The university consists of sixteen colleges, ten professional schools, and one graduate school, and has 135 research institutes and other supporting facilities, all of which are located across two campuses.

Gwanak Campus, the main campus of the university is located at the foot of the magnificent Gwanak Mountain in a 4.8 Km² area. The School of Medicine, Nursing and Dentistry and the University Hospital are all located on Yeongeon Campus in downtown Seoul.

SNU offers its students not only the most excellent academic environment possible but also outstanding cultural and recreational opportunities with a wide range of additional entertainment options available in the city of Seoul. SNU has a student enrollment of approximately 28,490; 16,511 at the undergraduate level and 11,979 at the graduate level. About 2,620 full-time faculty members are appointed at SNU. Over 330,000 SNU alumni play a leading role in every sector of South Korean and global society.

The Graduate School of International Studies (GSIS) has started as the Center for Area Studies in 1989 to foster research on region-specific issues and to respond to the increasing demand for global perspectives within Korea. In 1997, it has been expanded to the School of International and Area Studies (SIAS) which again expanded to current GSIS in 2003.

The school has a department of International Studies under which runs 4 Programs: International Commerce, International Cooperation, International Area Studies, and Korean Studies.

Since its foundation, GSIS achieved a remarkable success in its quality education of international studies. The objectives of GSIS education is to bring up experts on international and global affairs who meet the challenges of globalization and normalization, equipped with core skills, practicable expertise, problem-solving ability, international awareness, and visions. GSIS educates global leaders for an increasingly complex global society. As both a professional and academic institution, it seeks to prepare its students to assume leading roles in government and non-government organizations, international organizations, multinational corporations, the media, as well as think-tanks and universities. The curriculum is based on an integrated, multidisciplinary approach, which connects theory with practice.

With the most prominent faculty in Korea specializing in international commerce, international cooperation, international area studies, Korean studies, and Development Studies, GSIS provides a truly exceptional research and educational environment.

The student body is composed of highly qualified graduate students from all around the world. As a source of knowledge and skills, GSIS will continue to promote mutual understanding, peace, and prosperity, both regionally and globally.

2) Homepage:

- Seoul National University official website: <http://en.snu.ac.kr/>
- GSIS Official website: <http://gsis.snu.ac.kr/>

2. ACCOMMODATION

1) Dormitory of Seoul National University (SNU Gwanak Residence Halls)

Gwanak Residence Halls can accommodate 4,777 students from all over Korea and around the world. It provides residents with living quarters not only to study and relax but also to meet people from various backgrounds. Its double-occupancy (sharing a room basis) rooms are furnished with a shower room, two beds, two desks and two cabinets. Wifi service is available in each room.

- Homepage: <http://dorm.snu.ac.kr/eng/>
- Address: 1 Gwanak-ro, Gwanak-gu, Seoul 08826, Korea
- Tel: 82-2-881-9200 / Fax: 82-2-877-2892



(▲ SNU Gwanak Residence Halls for Graduate Students)

2) Layout of Double Occupancy room (2 people sharing a room)

A double occupancy room will be provided for your accommodation (shared rooms) in Gwanak Residence Halls Bldg. 900~905 and 918, which is the accommodation building for graduate students.

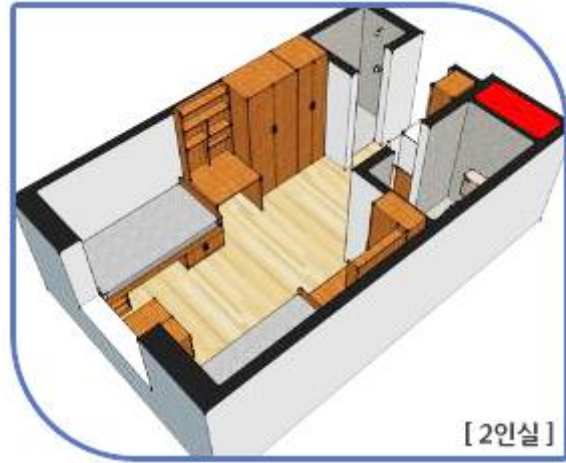

(▲ Double bed room)

3) Facilities

① Private Room

- A small refrigerator, a space separation screen and LAN cable provided
- A toilet and a shower booth
- Individual heating system
- Each room is furnished with two beds, two desks, two chairs, two book cases, two wardrobes, two shoe shelves and a curtain.
- Each room is equipped with an air conditioner, a telephone, LAN port and 220V power outlet.
- Personal Items including bed sheet, blanket and pillow are not provided.
- Possessing or using any of the electric heating appliances is prohibited.

② Common Area

- Kitchen: Microwave oven, cooking heater, refrigerator, water purifier, dining table, TV
- Laundry and drying room: Washing machine, electric iron, clothes horses
- Lounge: Snack vending machine, table, LAN port table for internet use
- Reading Room: Basement 1F, Building 900

③ Security

- CCTVs, card key, automatic door lock



(▲SNU dormitory buildings and facilities)

4) Documents to be submitted (Very Important)

SNU requires all dormitory residents to be immunized against certain communicable diseases. To comply with this regulation, Seoul National University Health Form (attached) <1. Immunizations (Measles)> and <2. Tuberculosis Screening> items should be completed and signed by your health care provider with the official seal of hospital. Required vaccinations should be given prior to arrival. Please submit soft copy (*.pdf) of your SNU Health Form to the office via email (koica.snu@gmail.com) by the designated date (TBA) and submit its original copy when you come to school on August 2019.

*(**The above documents will be required for only the applications who are accepted to the program. They will be submitted for the dormitory move-in application process.)*

3. OTHER INFORMATION



(▲GSIS Buildings)

- Administration Office

The Office for the National Development Policy for African Countries Program is located on the 3rd floor of the GSIS Bldg. 140 Room 203.

- Student ID Card (S-Card)

Paper application: Submit S-card application form and one COLOR PHOTO (3cm x 4cm) to the Student Support Center (Bldg. 67, Dure-moonyegwan 2nd Floor) at the beginning of the first semester after you obtain an Alien Registration Card and update your student records to reflect the new Alien Registration Number.

- Central Library

This is located behind the main administration building. You will need a student ID card to enter the library and to borrow books and other materials. Their website is <http://library.snu.ac.kr> which has extensive information. You can use your ID card to borrow and extend the due date of books.

- International Library

In response to the needs of a new, globalized era and demands for skillful international specialists, the GSIS Library was organized and has currently been enlarged. In addition to fostering prospective international specialists, the library has contributed to Seoul National University and played a pivotal role in building up the materials that are necessary and useful for domestic researchers of area studies. The library is preparing for the 21st century by producing and administering necessary materials. Recently it has developed into a branch library (International Studies Library) of Seoul National University and is open to various kinds of international as well as Korean researchers.

- Health Care Center

If there are any health problems, students have two nearest medical centers to choose from:

- ① The health team of Campus Health Service Center
(located on the 3rd floor of the Student Union Center) includes physicians, registered nurses, and a counselor and is equipped with a laboratory, radiology services, a pharmacy, and support staff. Students have to fill in the medical information card on their first visit to the center and present their student ID card or any other ID. The staff of Campus Health Service center can communicate in English. The operation hours are: Mon – Fri, from 09:00 to 17:30 (lunch break: 12:00 – 13:30). Please refer to the website listed below for more detailed information. (<http://health4u.snu.ac.kr/en/index.do>)
- ② Boramae Medical Center
Boramae Medical Center is the nearest and one of the finest medical centers from SNU. Please refer to the website for more detailed information. (<http://en.brmh.org/index.do>)

- Dining on Campus

There are more than 20 cafeterias and restaurants on the campus. Generally the menus on restaurants are a little more expensive compared to the ones served in the school cafeterias. The nearest place to eat in close to 906 Building is 901 Building cafeteria, or 220 Building cafeteria. Also “Our Home” cafeteria is available close to the dormitories. The school cafeteria serves breakfast, lunch, and dinner. Some of them are opened even during the weekends (“Our Home” and 919 Building Cafeterias). There is one restaurant offering Halal food and vegetarian food. Like most of the places in Seoul, the school cafeteria employs self-service system where you have to get yourself a coupon of the food that you want first, fall in line, get the serving tray and the utensils, and get the food that you paid for. Once you are done eating, you have to return everything in the kitchen. For a detailed map of school where you can locate the restaurants and cafeterias, please refer to the school website at:

(<http://en.snu.ac.kr/downloads?bm=v&bbsidx=117597>)

IV. ACADEMIC REGULATIONS

1. ATTENDANCE AND ABSENTEEISM

- Students are expected to attend all of the classes he/she has registered for each semester. Any student who, without good reason, fails to attend class for at least two-thirds of the total courses shall fail the course.
- In the event a student will be absent for any of the reasons below, the student must notify the appropriate department (Contact Program Administration Office), faculty, and dean and get approval in advance.
 - ① Death of an immediate family member (grandparents, parents, siblings) or equivalent circumstance
 - ② Academic planning, field-trips, on-location training, etc.
 - ③ Participation in seminars or conferences (including international ones) as approved by the Dean
 - ④ Other events as approved by the Dean
- In the event of student illness or emergency situations, students who will be absent for less than seven days (including holidays and weekend days) need to submit written notification of such absence to the Dean. For absences more than seven days, students must submit a written diagnosis by a physician.

2. MUST RESIDE IN A DORMITORY

- Students must reside in the Gwanak Residence Halls (dormitory) of Seoul National University.
- Living off-campus is not allowed.
- Seoul National University has very strict residency regulations and all students must abide by them.
- A student who violates residency regulations will be evicted from the KOICA Resident House and he / she must return to his / her country immediately.
- Cooking is only allowed in a dormitory cooking area
- Induction, microwave, and water purifier can be used. Each floor has a communal kitchen.
Cooking in a dormitory room is prohibited.

3. EXAMINATIONS AND GRADE EVALUATIONS

① **Minimum Grade Point Average Requirement**

Students must maintain a C- (70-73) grade point average at a minimum.

Anything below 70 points (F=69 and below) will be not be acknowledged as a passing grade.

- Regular Exams and Make-up Exams

② **Regular Exams: Mid-term and Final exams**

Make-up Exams (In the event a student cannot sit for an exam due to illness, or any other emergency, the student must notify the faculty in charge of class before the test date, and obtain Dean's approval to sit for the exam at another time)

③ **Qualification to sit for an Exam**

Any student who, without good reason, has failed to attend class for at least two-thirds of the total classes shall be prohibited from sitting for the exam. In the event of illness or emergency situations, students need to provide a written explanation of their absence.

④ **Scholastic Performance Evaluation Method**

Scholastic performance will be based on a 100 point score for each course registered. Grades will be based on classroom performance (presentations, attendance) and test performance (mid-term and final exams).

Grades will be calculated on a curve as follows:

- A to A+ : 30% of the students in the class
- B to A- : 40% of the students in the class
- B and below : 30% of the students in the class

V. REQUIRED DOCUMENTS

- All documents should be sent to the regional KOICA office or the relevant government office.
- 1) KOICA Application Form
- 2) Recommendation letter from applicant's governments
- 3) Document Checklist
- 4) Seoul National University Form 1: Application Form
- 5) Seoul National University Form 2: Personal Statement and Study Plan (**Type in English and Print out**)
- 6) Seoul National University Form 3: Recommendation from two different professors with stamp or signature on the sealed envelope by the recommender. (Download twice and to be completed by each of your two professors.)
- 7) Official Bachelor's Transcript and Degree/or Graduation Certificate (**Documents written in Korean or English are acceptable. Original Copy or Notarized Copy along with the Notarial Certificate.**) Transcripts and Certificates from Chinese universities MUST be accompanied by verification from the China Academics Degree & Graduate Education Development Center. Refer to the website <http://cdgdc.edu.cn>
- 8) A copy of the Applicant's Passport (or other official documents indicating your nationality)
- 9) Copies of Parents' passports (or other official documents indicating parents' nationality such as an Identification Card)
- 10) Official document indicating a parent-child relationship between the applicant and their parents: Applicant's Birth Certificate or Household Register proving the parent-child relationship (In the case of deceased parents or divorced parents, relevant proof needs to be submitted, such as Death Declaration Certificate or Divorce Certificate.)
- 11) Seoul National University Financial Certification Form 4
- 12) Seoul National University Form 5: Verification of Academic Record (Print out the form and sign your name on the Letter of Agreement. Do not fill out the Verification Report portion.)
- 13) Curriculum Vitae
- 14) Certification of Employment and Career Certificate
- 15) Certificate providing English Proficiency (Please submit a score report of a recognized English Proficiency Test such as TOEFL, TEPS, IELTS or any other supporting documents which demonstrate appropriate English language)

*** Refer to Seoul National University Form 1~5 attached separately.**

*** Important Notes for All Applicants:**

- All forms should be **typed in English** and all the supporting documents should be **in English**. **Documents in any other language should be accompanied by a notarized English translation.**
- **Original documents should be submitted. (If it is unavailable, the originating institution must authorize copies before they are submitted.)**
- **Submitted documents will not be returned. If the original documents are unavailable for submission, copies are suggested. In that case, however, the copies must be notarized.**
- If any of the submitted materials contain false information, admission will be rescinded.
- Applicants whose forms and supporting documents are incomplete or unsatisfactory will be disqualified from the admission process.
- Applicants should take full responsibility for any disadvantage due to the mistakes or omissions on the application.
- **Accepted Applicants, before enrollment, must submit their degree certificate (or diploma) and academic transcripts. The two documents, regardless of whether they are the original documents or copies, must be notarized by the Embassy of the Republic of Korea in the applicant's country or notarized via an apostille stamp.**

VI. CONTACTS

1. CONTACT INFORMATION

1) Korea International Cooperation Agency (KOICA)

· **Program Manager: Mr. Hyunseok KANG**

ODA Education Center

· Address: 825 Daewangpangyo-ro, Sujeong-gu, Seongnam-si, 461-833 Gyeonggi-do, Republic of Korea

· Tel: +82-31-740-0681

· Fax: +82-31-740-0765

· E-mail: hyunseok@koica.go.kr

· Homepage: <http://www.koica.go.kr>

· **Program Coordinator: Ms. Jinyeong JANG**

International Exchange Promotion Association

· Tel: +82-31-8017-2663

· Fax: +82-31-8017-2680

· E-mail: jenn@global-inepa.org

2) Graduate School of International Studies (GSIS)

Seoul National University (SNU)

· **Program Manager : Ms. Raemi Do**

· Address: GSIS Bldg. 140, Room 203, Seoul National University, 1 Gwanak-ro, Gwanak-gu, Seoul
(08826)

· Tel: +82-2-880-6877

· E-mail: koica.snu@gmail.com

· Homepage: <http://gsis.snu.ac.kr>

*** The schedule in PI (Program Information) is subject to change according to the KOICA and Graduate School of International Studies, Seoul National University Schedule.***